

# Technical Data Sheet



The United States of America:  
Peter Kwasny Inc.  
62-64 Enter Lane,  
Islandia, NY 11749

Distributed in

Canada by  
Peter Kwasny Spraypaint Canada Inc.  
2275 Lakeshore Blvd. West, Suite 530  
Toronto, ON. M8V 3Y3

Toll free North America  
Phone: 1-844-426-6330 / Fax: 1-866-226-6434  
order@kwasny.us / service@kwasny.us  
www.spraymax.com

**SprayMax®**  
**2K Topcoat black**  
**340 g NET WT. 12.0 oz**  
**Art. Nr. 3680222**



## Product

### Description / Purpose

For small damage repair jobs on existing gloss black surfaces for an easy and fast paint job of new or restored parts.

### Properties

- Easy to use
- High quality two component coating
- Very good flow
- Highest chemical and weather resistance
- Long lasting and very durable finish

### Material base

Base: special acrylic resins

Activator: Aliphatic polyisocyanates

### Colour

Black

### Gloss level

80 gloss units at 60° measuring angle

### Solid content

approx. 42 % by weight relating to the diluted paint

### EPA Coating Category

NFP Non Flat Coating

PWR Limit 1.40

### CARB Aerosol Rule Coating Category (01/2017)

TCC Two Component Coating

PWR Limit 1.20

## Substrate

Metal, Steel, Stainless Steel (cleaned and sanded).  
Depending on the surface select the appropriate  
Primer to achieve maximum adhesion and corrosion  
protection

Aluminum (cleaned and sanded).

SMC

Fiberglass

All plastics used in the automotive industries like  
ABS and PP/EPDM. To achieve maximum adhesion  
it is recommended to clean the surface thoroughly  
and apply SprayMax 1K Plastic Adhesion Promoter  
3680009.

Do not use on Polyethylene - PE

Wood (cleaned and sanded)

Glass, Ceramics (cleaned)

The damaged area must be dry and free of grease  
and dust and all rust needs to be removed.

## Processing

### Protection measures



Wear personal protection equipment.  
(respiratory mask / gloves / goggles)

For more information, see safety data sheet.

### Shake

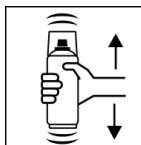

Before activating, shake can thoroughly for 2 minutes  
again from when the mixing balls are heard.

### Place red button

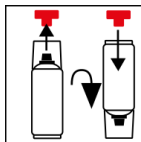

Remove the red button from the cap. Turn the can  
by 180° and fit the button onto the pin.

### Press red button

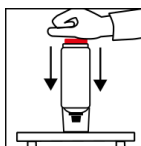

Turn the can upside down and place on a firm  
surface. Press the red button with the palm of your  
hand until it clicks into place.

**Shake**

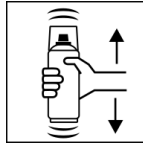

After activating, shake can again thoroughly for 2 minutes, again from when the mixing balls are heard.

**Adjustable Nozzle**

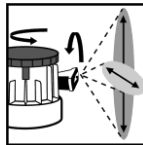

Set the variable spray nozzle to the size and pattern of the damage.

**Spray to test**

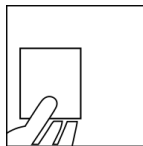

After shaking the can, test spray and check compatibility with the surface and the colour.

**Spraying distance**

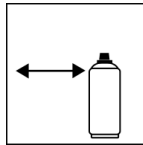

6 - 8 inches / 15 - 20 cm

**Spray passes**

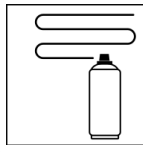

Dry film thickness 2 - 3 mil (50 - 75  $\mu$ m)  
(approx. 2 - 3 spray coats)

**Flash-off time**

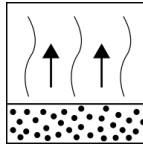

Flash time: approx. 10 min between each spray coat

**Processing conditions**



Optimum application at 64° F - 77° F (18° C - 25° C)  
and a relative humidity from 40 - 50 %.

**Drying**

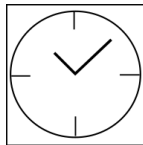

dust dry: 16 min  
dry to touch: approx. 3 h  
Ready for polishing: approx. 1 day

The stated values refer to the above mentioned processing conditions. The level of dryness is determined pursuant to DIN 53150.



IR drying possible,  
Respect technical manual

**Pot life**

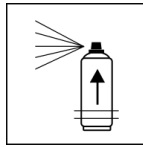

Approx. 24 h at 68° F (20° C) room temperature and a relative humidity of approx. 40 - 50 %.  
The processing time depends on the ambient temperature. Higher temperatures reduce the pot life, lower temperatures will prolong it.

**Finish**

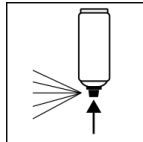

After painting, turn the can upside down and spray the valve until empty.

**Additional Information**

**Shelf Life**

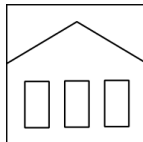

36 months (not activated)  
The usage period refers to an unused can that is stored correctly at a temperature of 68° F / 20° C and a relative humidity below 60%. The can must be stored and transported in an upright position in a dry place where it is protected against chemical and mechanical influences. The safety information on the can and all statutory provisions applicable for the storage site must be observed.

**Disposal**



The completely emptied spray cans must be disposed of in the recycling system. Cans with hardened material must be disposed of as special waste.

**Note**

For professional use only.  
Identification, see safety data sheet.

The contents in this technical data sheet were created with great care and reflect our current state of knowledge. They provide the user with application-specific information and do not promise certain properties. The information is non-binding and we accept no liability for its integrity, accuracy and completeness. They do not relieve the user of their duty to check the suitability of our product for the intended purpose. The warnings printed on our labels must be respected. Our brands and patents are protected by copyright. All rights reserved. We reserve the right to update, amend or supplement the content of the information without prior notice.